

CONSTRUCTION NOTES

1. EXISTING CONDITIONS INFORMATION IS DERIVED FROM A SURVEY PREPARED BY THE OFFICE OF PUBLIC AND BOATING ACCESS AND FROM RECORD PLANS.
2. FROM THE START OF ANY EXCAVATION FOR THE PROJECT, BOTH ON AND OFF THE SITE, THE CONTRACTOR SHALL BE RESPONSIBLE FOR THE PROTECTION OF ALL EXISTING UTILITIES. THE CONTRACTOR SHALL BE RESPONSIBLE FOR THE PROTECTION OF ALL EXISTING UTILITIES THAT HAVE BEEN LOCATED AND MARKED.
3. CONTRACTOR TO ADJUST UTILITY DEPTH TO BE FLUSH WITH GRADE (ELEVATION) WITHIN THE EXCAVATION TO BE MAINTAINED. ALL UTILITIES SHALL BE PROTECTED BY THE WORK ON GRADE CHANGES. UTILITIES DEPTHS SHALL BE SHOWN ON PLANS OR NOTED.
4. ALL CONSTRUCTION TO BE DONE IN ACCORDANCE WITH TOWN OF HAMILTON DEPARTMENT OF PUBLIC WORKS STANDARDS.
5. THE LOCATION OF EXISTING UNDERGROUND UTILITIES ARE SHOWN IN AN APPROXIMATE WAY ONLY AND SHALL BE VERIFIED BY THE CONTRACTOR. THE CONTRACTOR SHALL BE RESPONSIBLE FOR THE PROTECTION OF ALL EXISTING UTILITIES. THE CONTRACTOR SHALL BE RESPONSIBLE FOR THE PROTECTION OF ALL EXISTING UTILITIES THAT HAVE BEEN LOCATED AND MARKED. THE CONTRACTOR SHALL BE RESPONSIBLE FOR THE PROTECTION OF ALL EXISTING UTILITIES THAT HAVE BEEN LOCATED AND MARKED.
6. WHERE AN EXISTING UTILITY IS FOUND TO CONFLICT WITH THE PROPOSED WORK, THE LOCATION, ELEVATION, AND SIZE OF THE UTILITY SHALL BE ADEQUATELY RECORDED BEFORE ANY EXCAVATION. THE CONTRACTOR SHALL BE RESPONSIBLE FOR THE PROTECTION OF ALL EXISTING UTILITIES THAT HAVE BEEN LOCATED AND MARKED.
7. THE CONTRACTOR SHALL MAINTAIN THE MARKING OF THE TOP SECTION OF ALL EXISTING UNDERGROUND UTILITIES AS SHOWN ON THE PLANS. THE CONTRACTOR SHALL BE RESPONSIBLE FOR THE PROTECTION OF ALL EXISTING UTILITIES THAT HAVE BEEN LOCATED AND MARKED.
8. THE CONTRACTOR SHALL MAINTAIN ALL PERMITS FOR THE ALTERATION AND ADJUSTMENT OF ALL EXISTING UTILITIES. THE CONTRACTOR SHALL BE RESPONSIBLE FOR THE PROTECTION OF ALL EXISTING UTILITIES THAT HAVE BEEN LOCATED AND MARKED.
9. CONTRACTOR SHALL MAINTAIN, ON ADJACENT TO NEW PAVED DRIVE, AS NECESSARY ALL UTILITY AND SITE STRUCTURES SUCH AS LIGHT POLES, SIGN POLES, CATCH BASINS, HAND HOLES, ETC. WITHIN THE EXCAVATION TO BE MAINTAINED. THE CONTRACTOR SHALL BE RESPONSIBLE FOR THE PROTECTION OF ALL EXISTING UTILITIES THAT HAVE BEEN LOCATED AND MARKED.
10. AREAS OUTSIDE THE LIMITS OF PROPOSED WORK DELIMITED BY THE CONTRACTOR'S OPERATIONS SHALL BE RESTORED TO THEIR ORIGINAL CONDITION, AT THE CONTRACTOR'S EXPENSE.
11. SCHEDULED MAINTENANCE SHALL BE CONDUCTED IN ACCORDANCE WITH THE TOWN OF HAMILTON DEPARTMENT OF PUBLIC WORKS STANDARDS. THE CONTRACTOR SHALL BE RESPONSIBLE FOR THE PROTECTION OF ALL EXISTING UTILITIES THAT HAVE BEEN LOCATED AND MARKED.

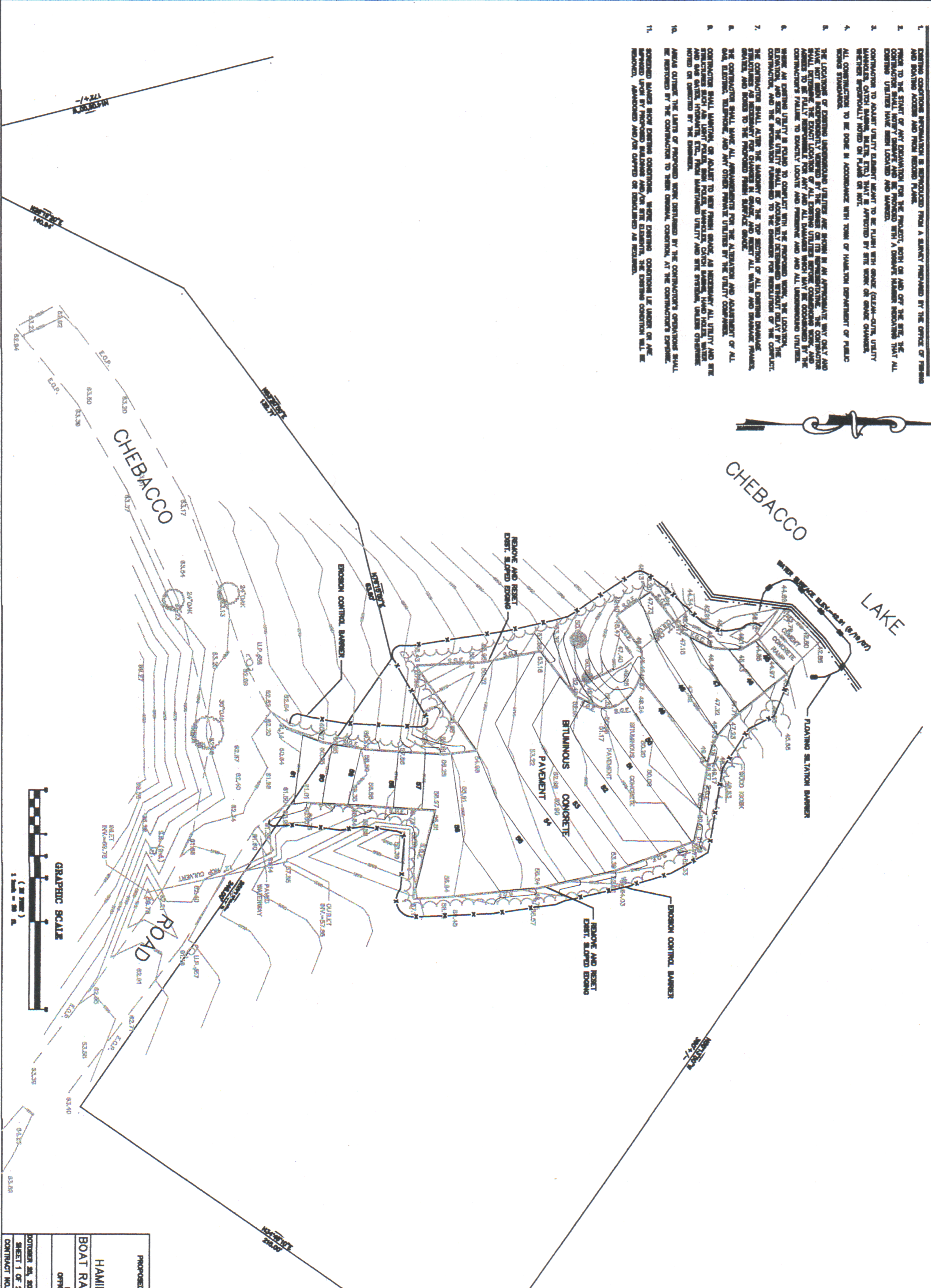

LEGEND

- BT. CON. BITUMINOUS CONCRETE
- CONC. CONCRETE
- PROP. PROPOSED
- ROADS
- TY. TYPICAL
- UNDERGROUND
- EXST. SPOUT ELEV.
- SLOPED GRADE EXPOSE
- VERTICAL GRADE CURB
- ENGINE CONTROL BARRIER
- FLOATING BOLLARD BARRIER

PROPOSED PUBLIC ACCESS FACILITY IMPROVEMENTS
 BOAT RAMP IMPROVEMENTS
 CHEBACCO LAKE
 HAMILTON, MASSACHUSETTS
 DEPARTMENT OF FISH AND GAME
 OFFICE OF PUBLIC AND BOATING ACCESS

CONTRACT NO. PA-280
 SHEET 1 OF 2
 PLAN NO. E-497